

## NPD6-100Ah

Valve-regulated lead-acid battery



## DEEP CYCLE SERIES

### Characteristics

Nominal voltage	6V (3 cell per unit)	
Nominal capacity at 10 hours rate/5.4V (25°C)	103Ah	
Capacity (25°C)	20 Hours rate/5.4V	109.2Ah
	5 Hours rate/5.4V	88Ah
Terminal type	T14	
Torque	5.1±0.6N.m	
Approx. internal resistance (25°C)	2.8 mΩ	
Dimensions	Length	194±2mm (7.64inch)
	Width	170±2mm (6.69inch)
	Height	205±2mm (8.07inch)
	Total height	210±2mm (8.27inch)
Design Life (stand-by)	JIS at 25°C	10 years
	Eurobat at 20°C	10-12 years
Weight	16.00kg (35.30lbs)±3%	
Nominal operating temperature	25°C±3 (77±5°F)	
Operating temperature range	Discharge	-15°C~50°C (5°F~122°F)
	Charge	-10°C~50°C (14°F~122°F)
	Storage	-20°C~50°C (-4°F~122°F)
Float charging voltage at 25°C	6.75V~6.90V	
Cyclic charging voltage at 25°C	7.25V~7.50V	
Temperature compensation	Float charge	-9 mV/°C/Block
	Cycle charge	-15 mV/°C/Block
Max. charging current (A)	30.0A	
Max. discharge current for 5 seconds	800A	
Self discharge rate (25°C)	≤3%/month	
Battery container ABS UL94-HB	V-0 optional	

### Overview

NPP Power Deep Cycle Series are manufactured specifically to provide outstanding performance in deep cycling applications. The batteries are designed using enhanced alloy contents plates and active paste materials.

### Dimensions & Terminal Type (mm)

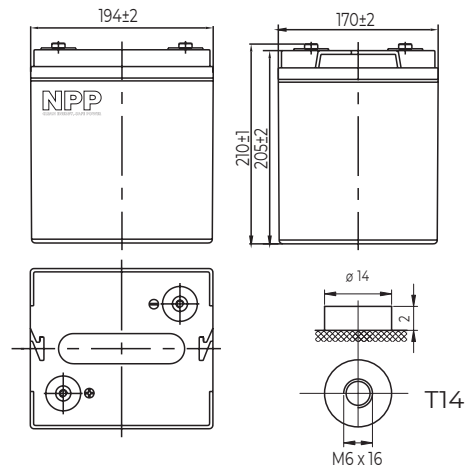

### Certification & Compliances



Compliant to: EUROBAT, RoHS, WEEE's and Reach.  
Manufactured according to IEC 60896-21 / 22

### Construction

Component	Positive Plate	Negative plate	Container	Separator	Electrolyte	Safety valve	Terminal
Raw material	Lead dioxide	Lead	ABS (V-0 opt.)	AGM	Sulfuric Acid	Rubber	Copper

### Constant current discharge characteristics at 25°C

(Ampere/battery)

F.V/Time	10min	15min	30min	60min	2hr	3hr	4hr	5hr	8hr	10hr	20hr
4.80V	225	173	104	63.7	37.6	27.1	21.6	18.5	12.7	10.5	5.56
4.95V	218	169	101	62.7	37.4	26.9	21.5	18.4	12.6	10.5	5.55
5.10V	209	163	98.3	61.1	37.1	26.8	21.4	18.3	12.6	10.4	5.53
5.25V	200	157	96.0	59.2	36.5	26.6	21.2	18.1	12.5	10.4	5.50
5.40V	189	149	92.4	57.3	35.6	25.8	20.6	17.6	12.1	10.3	5.46

### Constant power discharge characteristics at 25°C

(Watts/battery)

F.V/Time	10min	15min	30min	60min	2hr	3hr	4hr	5hr	8hr	10hr	20hr
4.80V	1213	950	581	363	218	159	127	109	75.5	62.6	33.3
4.95V	1176	927	569	357	217	158	127	109	75.1	62.5	33.3
5.10V	1128	893	552	348	215	157	126	108	74.5	62.3	33.2
5.25V	1079	863	538	337	211	156	125	107	74.0	61.9	33.0
5.40V	1019	817	519	327	206	152	121	104	71.8	61.5	32.8

The above characteristics represent average values and can be obtained within three charge and discharge cycles. The batteries must be fully charged before testing. The data in this document is subject to change without notice and become contractual only after written confirmation. Please contact NPP Power for the latest available version.

#### NPP Power (Vietnam) Co.,Ltd

Lot A22.3, Road C4, Thanh Thanh Cong Industrial Zone,  
An Hoa Village, Trang Bang District, Tay Ninh Province,  
Vietnam

#### Guangzhou NPP Power Co, Ltd.

No.67 Lianglong Road, Huashan Town, Huadu District,  
Guangzhou, China  
Email: info@nppower.com.cn Tel. +86 20 37887 390